

Good Neighbor Authority Sale Area Map

Wisconsin Department of Natural Resources

Penokee Pine Sale
 Great Divide Ranger District
 Chequamegon-Nicolet National Forest
 T44N R3W Sec 6 & T45N R4W Sec 26
 Ashland County, WI
 Tract 8003-09-19
 35 acres

- Red Pine Thinning (35 acres): Cut all blue marked trees. Do not cut orange-ringed trees (with blue trail markers) along North Country Trail. Sale area bounded by orange and red paint line and Hanson Rd (FR 188).
- Seasonal Restriction Area: Harvesting only allowed from September 16 to May 14.
- Winter Only Harvest Area: Harvesting only allowed from December 12 to March 14.

Legend

- Orange Paint Line (Sale Boundary)
- Red Paint Line (Private Boundary)
- Town Road
- Woods Road
- North Country Trail
- Berm
- Gate
- Private Property
- Section Corner

660 0 660 1320 1980 2640 ft

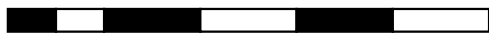

Scale 1:15840



Sale Prepared by:
 Steve Lorenz
 WDNR Forester

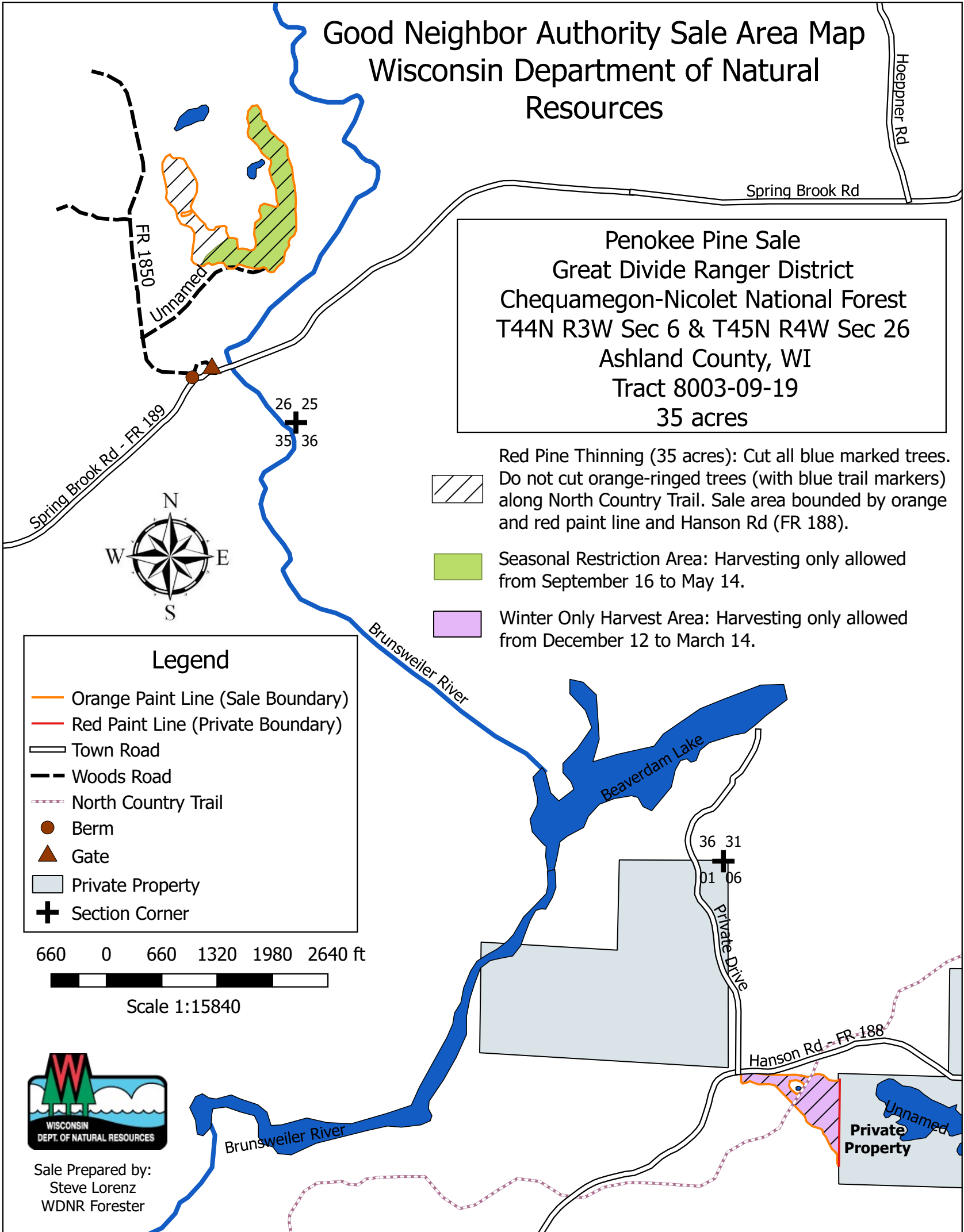



Good Neighbor Authority Timber Sale

Penokee Pine Sale

Great Divide Ranger District

Chequamegon-Nicolet National Forest

Tract # 8003-09-19

Location:

Town	Range	Section	Description
44N	3W	6	NWSW
45N	4W	26	SWNE, SENE, NWSE, NESE

Sale Area: 35 Acres

SPECIES	VOLUME
Red Pine	590 Cords
Mixed Hardwood	50 Cords
Aspen	15 Cords
Basswood	10 Cords

- Red Pine volume is advertised as mixed product and will be sold and scaled as cordwood.
- Red Pine mixed product includes 120 MBF based on 8" small end DIB and 300 cords pulpwood.
- Mixed Hardwood volume includes less than 1 MBF and consists of 90% hard maple and 5% red maple. The remaining 5% consist of ash and white birch.
- Red Pine conversion rate is 2.25 tons/cord.
- Mixed Hardwood conversion rate is 2.44 tons/cord.
- Aspen conversion rate is 2.25 tons/cord.
- Basswood conversion rate is 1.925 tons/cord.

Minimum Bid Value: \$11,874.00

Harvest Requirements:

C212 S17 Red Pine Thinning (10 acres): Cut all trees marked in blue paint. Do not cut orange-ringed trees (with blue trail markers) along North Country Trail. A 10-foot slash removal zone is required along the adjacent private property line (marked in red paint) as well as along Hanson Rd. A 25-foot slash removal zone is required along the North Country Trail. Slash must be kept to less than or equal to 24 inches for up to 150 feet from Hanson Rd and the North Country Trail. Harvesting is only allowed from December 12th through March 14th (to maintain scenic integrity along the trail).

C225 S11 & 12 Red Pine Thinning (25 acres): Cut all trees marked in blue paint. For 2/3 of the eastern part of the sale area, harvesting is only allowed from September 16th through May 14th (to protect an endangered resource).

Sale is bounded by orange and red paint line and a small portion of Hanson Rd (FR 188).

Additional Requirements:

- This Contract Period is 2 Years.
- Timber harvesting may not begin without prior notification and an on-site meeting with a Wisconsin DNR sale administrator.
- Much of the sale area has seasonal restrictions—see map for clarification. A small portion can be harvested at any time of year. Sale administrator can flag restricted portion if requested.

- All pine products cut between May 1 and September 1 must be removed from the sale area within 3 weeks from the time of cutting. Pine products cut during the remainder of the year must be removed prior to May 1 of each year.
- No slash or machine operation allowed outside of orange painted boundaries.
- All slash must be kept clear of travel ways at all times, removed from the area 10 feet from road and private property edges, and kept out of wetlands and riparian areas.
- Equipment must be inspected by sale administrator prior to entering sale area and must be clean of dirt and debris.
- Known areas with a weed infestation will be flagged by sale administrator and avoided during operations.
- Sale will be mill scaled sale and billed using the mill ticket system.
- No bid bond required, a performance bond of 15% of the total sale bid value will be required. 2 year contract period.
- Reserve all snags that do not pose a safety risk.
- Safety signs are required on public trails and roads entering active harvest areas.
- The harvesting of any portion of a tree that lies outside the physical ownership of the Forest Service will not be allowed. Trees lying across the property line must be bucked at the ownership line and all portions of the tree that reside on the private side of the line must be left in place. Conversely, the remaining portion of the tree that lies within the physical ownership of the Forest Service may be harvested and utilized.

Roads and Skid Trails:

- Forest plan requires that all native surfaced approaches to paved or graveled roads have 100' of gravel put down 6 inches thick and 12 feet wide when used during non-frozen conditions.
- All landings and skid trails will be blocked to vehicular access and possibly re-seeded at the conclusion of use if needed.
- Temporary Roads shall have the road base constructed to a width of 12 feet or narrower, and with vegetative clearing of trees and brush not to exceed a width of 25 feet. Exceptions to the 12-foot maximum width of the road base may be granted by the sale administrator. Exceptions would typically be granted for sections of temporary roads where tight turns, curves, and terrain create a need so that trucks and equipment can be operated safely.
- FR 1850 and all Unnamed woods roads must be restored to pre-sale condition or better and closed with an earthen/debris berm at the existing location on the map and extend for 100 feet beyond.
- All road maintenance and rehabilitation post-harvest is the purchaser's responsibility. A sample contract including road maintenance specifications can be obtained by request. Contact WDNR Forester David Todus at (715) 577-1806 for more information.
- North Country Trail must always be kept clear from debris. Skidding on trails is prohibited except at crossings designated by the timber sale administrator. No wheeled or tracked vehicles may operate within 10 feet of the trail except at designated crossings.