



# HABANERO

Tract #8002-02-23, 57 acres

Good Neighbor Authority Sale Area Map  
Wisconsin Department of Natural Resources

Eagle River-Florence Ranger District  
Chequamegon-Nicolet National Forest  
T38N R11E, Section 23,24,25 - Oneida County, WI  
DNR Contact: Kelsey Dencker: (715) 216-0286  
Jason Headson: (715) 508-0129

## Legend

- Red Paint Line
- Orange Paint Line
- = Double-Sided Orange Paint Line
- Frozen Ground Only
- Seasonal Restriction (Harvest 10/2 - 3/31)
- Lakes and Rivers
- Private Boundary
- Highway
- Town Roads
- Woods Roads
- Hunter Walking Trails
- Roadwork
- Snowmobile Trail
- + Section Corner

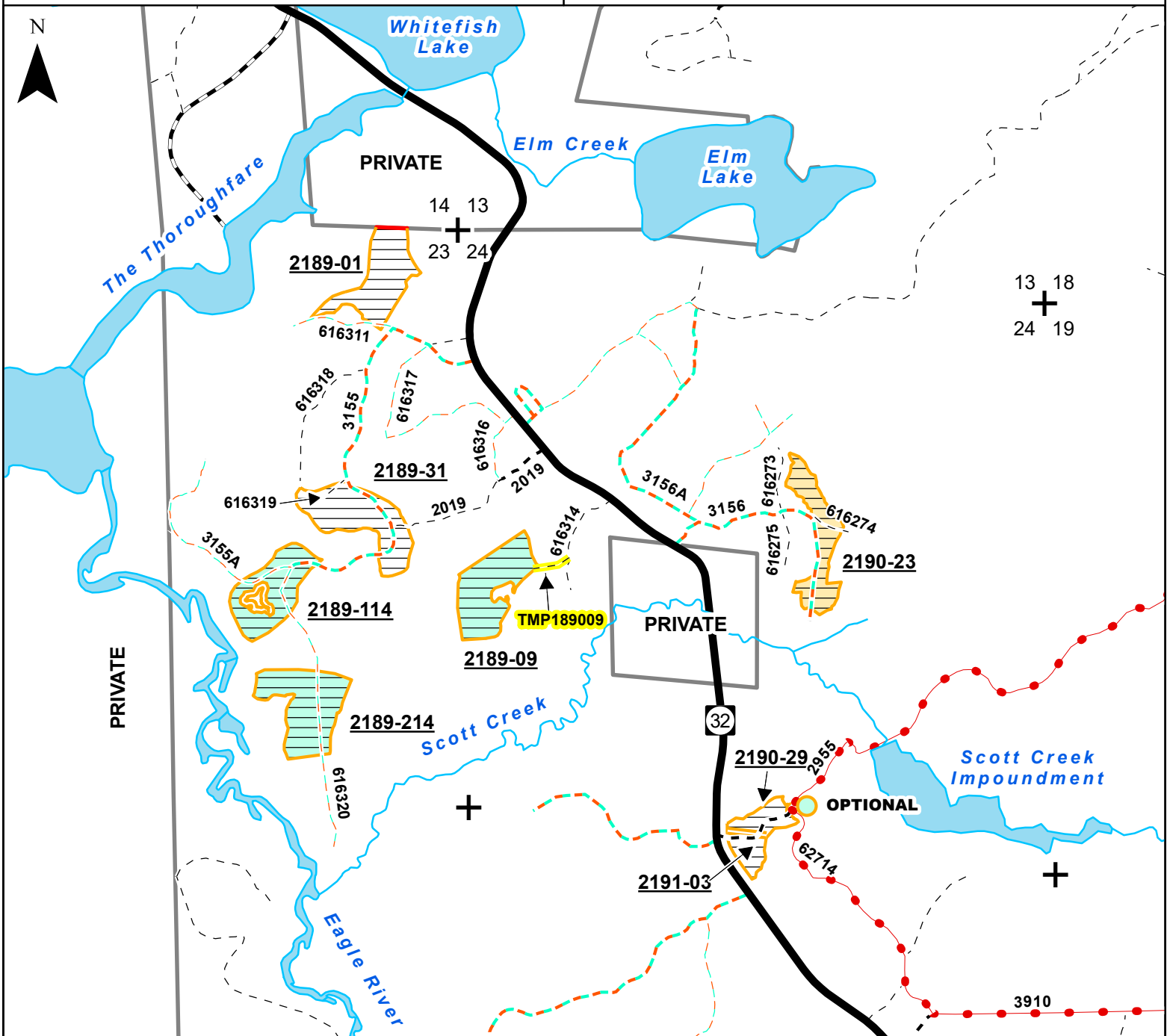

**Unit #1 - Aspen Clearcut (57 acres):** Harvest all aspen, balsam fir, maple, spruce, tamarack and paper birch greater than 1-inch diameter except those marked with orange paint or within the orange-painted exclusion in Stand 2189-114.

- **OPTIONAL Harvest Area** in Stand 2190-29 east of 62714, designated with double-sided orange paint line. **Invasives present.**
- Stands 2189-09, 114, 214 & OPTIONAL: Harvesting and hauling may only occur under frozen ground conditions.
- No mechanical activities allowed within Stand 2190-23 from April 1st to October 1st.
- Harvesting may occur during dry, firm, or frozen ground at the discretion of the timber sale administrator in all other stands.



**Good Neighbor Authority**  
**Wisconsin Department of Natural Resources**  
 Eagle River/Florence Ranger District  
 Chequamegon-Nicolet National Forest

**HABANERO - Prospectus**  
**Tract #: 8002-02-23**

**Location:** Oneida County, WI    **Sale Area:** 57 acres

Town	Range	Section	Description
38N	11E	23	E1/2
38N	11E	24	SWNE, NWSE, SWSE, SESW, NWSW
38N	11E	25	NENW, NWNE

**Estimated Volumes and Values:**

Species	Volume
Aspen pulp	2450 T
Balsam fir pulp <sup>1</sup>	700 T
Mixed hardwood pulp <sup>2</sup>	370 T
<b>Minimum advertised bid:</b>	<b>\$26,484.00</b>

All volume estimates were obtained using cubic cruise' volume estimating system. Oneida County base stumpage rates used for aspen and balsam fir product values. Forest County base stumpage rate used for mixed hardwood product value.

1. Balsam fir pulp contains 83% balsam fir, 16% spruce (including 3.6 MBF) and 1% tamarack.
2. Mixed hardwood pulp contains 89% red maple (including 3.3 MBF) and 11% paper birch (including 0.6 MBF).

**General Harvest Information and Special Conditions:**

- No sale work may begin without prior notification and an on-site meeting with the sale administrator.
- Billing for pulp and bolt products will use a mill scale ticket system.
- No bid bond required. A performance bond of 15% of the total sale bid value will be required.
- The contract period is **3 YEARS, ending June 30<sup>th</sup>, 2026.**
- Cutting areas are bounded by orange and red paint lines or established roads. See sale map.
- Harvesting in cutting areas (stands) must be completed prior to moving to another cutting area. Cutting must be concurrent for all species including required 1-5" diameter stems.
- Reasonable care shall be taken to avoid unnecessary damage to residual trees and regeneration.
- Utilization to at least a 4-inch top.
- The harvesting of any portion of a tree that lies outside the physical ownership of the Forest Service will not be allowed. Trees lying across the property line must be bucked at the ownership line and all portions of the tree that reside on the private side of the line must be left in place. Conversely, the remaining portion of the tree that lies within the physical ownership of the Forest Service may be harvested and utilized.
- Equipment must be cleaned and inspected before entering and leaving sale area to prevent the introduction/spread of invasive species.
- All slash shall be pulled 10 feet from the edge of all roads, trails, private land, wetlands and riparian areas, and shall be lopped and scattered to lie within 2 feet of the ground for 100 feet from WI-32. All other slash shall be lopped and scattered to lie within 4 feet of the ground.
- In all harvest areas, do not cut standing snags unless they pose a safety risk.
- **See cutting prescriptions and seasonal restrictions listed on the map.**

### Road and Skid Trails:

- **Flagged Temporary Road, TMP189009 (0.06-mile), from 616314 to access Stand 2189-09 will be purchaser's responsibility to construct.**
- **Invasive Area:** Due to the presence of reed canary grass, portions of 62714 and 2955 to access **OPTIONAL Harvest Area in Stand 2190-29 may only be used under frozen ground conditions.** Remaining segments of roads may be used during surface firm or frozen conditions.
- Purchaser required to post signs on public trails and roads entering active harvest areas alerting recreationalists of harvest activities.
- Purchaser is responsible to obtain written permission from local town to deck wood on town roads.
- Chequamegon-Nicolet Forest Plan requires that all native surfaced approaches to paved or graveled roads have 100 ft. of gravel, 6 in. deep, 12 ft. wide laid down when used during non-frozen conditions.
- All landings and skid trails will be blocked to vehicular access after use.
- Any new temporary roads or turn-arounds will need approval by the timber sale administrator.
- The location and clearing widths of all Temporary Roads shall be agreed to in writing before construction is started. "Temporary Roads" are roads other than Specified Roads that are constructed by Purchaser for the purpose of harvesting included timber.
- Temporary Roads shall have the road base constructed to a width of 12 feet or narrower, and with vegetative clearing of tree and brush not to exceed a width of 25 feet. Exceptions to the 12-foot maximum width of the road base may be granted by the sale administrator. Exceptions would typically be granted for sections of temporary roads where tight turns, curves, and terrain create a need so that trucks and equipment can be operated safely.
- **Hunter Walking Trails are present throughout this sale.** These trails may be used for timber sale access but must be left slash and rut-free post-harvest to facilitate future mowing.
- **The following Hunter Walking Trails must be bermed if they are used for trucking: 3155A, 616311, 616274, and 616320.** In order to berm trails as required, Purchaser shall, at locations designated by the Sale Administrator, construct **one berm** at least four feet in height and shall be made with dirt mixed with rocks, stumps, logs, root-wads, or slash and shall be constructed without creating a defined trench.
- **The following roads must be double-bermed if they are used for trucking: 616273, 616275, 616314, 616318, 616319, and TMP189009.** In order to double-berm roads as required, Purchaser shall, at locations designated by the Sale Administrator, construct **two berms** at approximately 75-foot intervals with scattered slash and logging debris between the mounds. Berms shall be at least four feet in height and shall be made with dirt mixed with rocks, stumps, logs, root-wads, or slash and shall be constructed without creating a defined trench.
- All road maintenance and rehabilitation post-harvest is the purchaser's responsibility.

**Road Restrictions List:**

Road	Termini		Code	Description of Restrictions
	From	To		
WI-32	3155	2955	O	State Highway. Signage required while sale active.
3155*	WI-32	3155A	O	Open Hunter Walking Trails. Use during surface firm or frozen conditions. Signage required while sale active.
3156*	WI-32	616274		
2955	WI-32	62714	O	Open Road. Use during surface firm or frozen conditions. Signage required while sale active.
2955 <i>Invasives</i>	62714	Edge of Sale	O, A	Snowmobile Trail. <b>Invasives present. Use only under frozen ground conditions.</b> Hauling prohibited on Snowmobile Trails on Federal Holidays, weekends (noon Friday through midnight Sunday), and between Christmas and New Year's Day. At all times during the snowmobile season, keep at least 4" of packed snow on the trail. Keep trail ROW (10' from edge of trail) free of debris resulting from purchaser's operations. Signage required while sale is active.
62714 <i>Invasives</i>	2955	Edge of Sale	R, A	
2019	3155	Edge of Sale	R	Closed Roads. Use during surface firm or frozen conditions. Double-berm if used for trucking.
616273	3156	End of Use		
616275	3156	End of Use		
616314	WI-32	TMP189009		
616318	3155	End of Use		
616319	3155	End of Use		
3155A*	3155	End of Use	R, A	Closed Hunter Walking Trails. Use during surface firm or frozen conditions. Single-berm if used for trucking.
616274*	3156	End of Use		
616311*	3155	End of Use		
616320*	3155	End of Use		
<b>TMP189009</b>	616314	Stand 2189-09	U	<b>Temp Road Construction.</b> Use during surface firm or frozen conditions.
2019	WI-32	Edge of Sale	P	<b>Do not use for sale access.</b>

\*Hunter Walking Trails

<u>Code</u>	<u>Use Limitations</u>
A	Public use restriction
O	Road may be used without restriction, unless unreasonable damage is caused
P	Use prohibited
R	Hauling restricted
U	Unsuitable for hauling prior to completion of agreed reconstruction

**Road Maintenance Requirements Summary:**

- Purchaser shall maintain roads, commensurate with Purchaser's use. Roads must be left in as good or better condition than existed prior to harvest. Performance of road maintenance work by Purchaser may be required prior to, during, or after each period of use. The timing of work accomplishment shall be based on Purchaser's operating schedule and road conditions. Specific required road maintenance specifications are included below.
- Purchaser shall maintain roads in accordance with the following Contract Road Maintenance Requirements Summary below:

Road	Termini		Miles	Timing: Pre Haul During Post Haul	Applicable Road Maintenance Specifications		
	From	To			8110	8420	8130
WI-32	3155	2955	1.02	N/A	None Required – State Highway		
3155*	WI-32	3155A	0.81	All Above	X	X	X
3156*	WI-32	616274	0.45	All Above	X	X	X
2955	WI-32	62714	0.16	All Above	X	X	X
2955 Invasives	62714	Edge of Sale	0.03	During		X	
62714 Invasives	2955	Edge of Sale	0.04	During		X	
2019	3155	Edge of Sale	0.03	All Above	X	X	
616273	3156	End of Use	0.12	During Post Haul	X	X	
616275	3156	End of Use	0.09	During Post Haul	X	X	
616314	WI-32	TMP189009	0.20	During Post Haul	X	X	
616318	3155	End of Use	0.26	During Post Haul	X	X	
616319	3155	End of Use	0.10	During Post Haul	X	X	
3155A*	3155	End of Use	0.10	During Post Haul	X	X	
616274*	3156	End of Use	0.10	During Post Haul	X	X	
616311*	3155	End of Use	0.20	During Post Haul	X	X	
616320*	3155	End of Use	0.51	During Post Haul	X	X	
TMP189009	616314	Stand 2189-09	0.06	All Above	X	X	X

\*Hunter Walking Trails

<u>Specification No.</u>	<u>Specification Title</u>
T-8110	Maintenance Blading/Grading
T-8420	Cutting Roadway Vegetation
T-8130	Spot Surface Course Placement/Replenishment

- **T-8110: Maintenance Blading/Grading** is keeping an aggregate surfaced roadbed in a condition to facilitate traffic and provide proper drainage. It includes maintaining the crown, inslope or outslope of the traveled way, turnouts, and shoulder; repairing berms; blending approach road intersections; and cleaning drainage dips and lead-off ditches.
- **T-8420: Cutting Roadway Vegetation** includes removal of brush, trees and other vegetative growth from within the clearing limits. This may include brush mowing of shoulders to prevent larger growth which would inhibit travel in the future.
- **T-8130: Spot Surface Course Placement/Replenishment** includes subgrade preparation, furnishing, hauling, spreading and shaping materials in accordance with the requirements.

Last modified by KD: 8/28/2023 1:43 PM

**Notice:** Completion of this form is mandatory. The Department will not recognize your bid unless you complete and submit this form. Personal information collected will be used for program administration and may be provided to requesters as required by Wisconsin's Public Records law [ss. 19.31-19.39, Wis. Stats.].

Date
------

Bidder Name
-------------

Street Address	City	State	ZIP Code
----------------	------	-------	----------

Property Name (if any) Chequamegon-Nicolet National Forest - Eagle River - Florence District GNA	Timber Sale Name HABANERO	Tract Number 8002-02-23
---	------------------------------	----------------------------

Date and Hour of Bid Opening September 14th, 2023 @ 9:00 AM	Minimum Acceptable Bid (optional) \$26,484.00
--	--

Species-All bids including Lump Sum bids must be by species	Utilization Specifications (4 inch/Whole Tree/Logs)	Estimated Volume	Volume Units (tons/cords/mbf)	Price Bid Per Unit	Total Bid Value on Estimated Volume
Aspen pulp	4 inch	2,450	T		
Balsam fir pulp	4 inch	700	T		
Mixed hardwood pulp	4 inch	370	T		

The award shall be based on this TOTAL BID AMOUNT:

**Performance Bond** Will be in the form of: (select one)

Personal Check
  Assurance Bond  
 Certified Check/Money Order
  Certificate of Deposit  
 Irrevocable Letter of Credit
  Assignment of Savings Account

I understand that any or all bids may be rejected and that consideration and awarding of a contract will be based upon my past performance and ability to complete contracts. **I also understand that if I am the winning bidder, I have 6 weeks from the date of the bid opening to submit an acceptable performance bond. I also understand that if I am awarded the contract and fail to execute it or work under it, I will be required to forfeit to the Department an amount equal to 10% of my total bid amount.** Failure to forfeit the 10% penalty will result in being considered ineligible to bid on any state timber sales for a two-year duration. In the event the highest bidder can not or will not sign the contract, the award may be made to the next highest qualified bid.

By checking this box, I certify that I hold a Wisconsin Master Logger Certification.

**Notice:** I understand:

Utilization specifications and estimated volumes are listed in the prospectus which is available upon request from the Department.

A copy of the standard timber sales contract which must be entered into is available upon request from the Department.

Signature of Bidder
Bidder's Name (Please Print or Type)
Phone Number (include area code)
Email Address