

Tract 14-21 (Phantom Skunk Sale) - Flambeau River State Forest  
 WNW, SW, Sec. 6, T37N-R3W; NE, SE, Sec. 1, T37N-R4W, Sawyer County

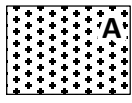

**A: Aspen Coppice (55 acres)** - Bounded by RED paint. Cut all trees greater than 1" EXCEPT:  
 1) hemlock, 2) pine, 3) oak, 4) cedar, 5) yellow birch, 6) elm, 7) tamarack, 8) trees marked in GREEN paint.

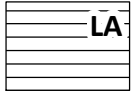

**LA Larch-Aspen Area (27 acres)** - Bounded by RED paint. Cut all trees greater than 1" EXCEPT: 1) hemlock, 2) pine, 3) oak, 4) cedar, 5) yellow birch, 6) elm, 7) tamarack, 8) trees marked in GREEN paint.

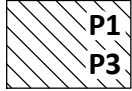

**P1 P3 Red Pine 1st Thinning (14 acres)/Red Pine 3rd Thinning (7 acres)** - Bounded by RED paint. Cut all trees marked in ORANGE paint. Cut all aspen.



**SW White Spruce-Aspen Conversion (7 acres)** - Bounded by RED paint. Cut all trees greater than 1" EXCEPT: 1) hemlock, 2) oak, 3) cedar, 4) elm, 5) tamarack, 6) trees marked in GREEN paint. Sever all ironwood.

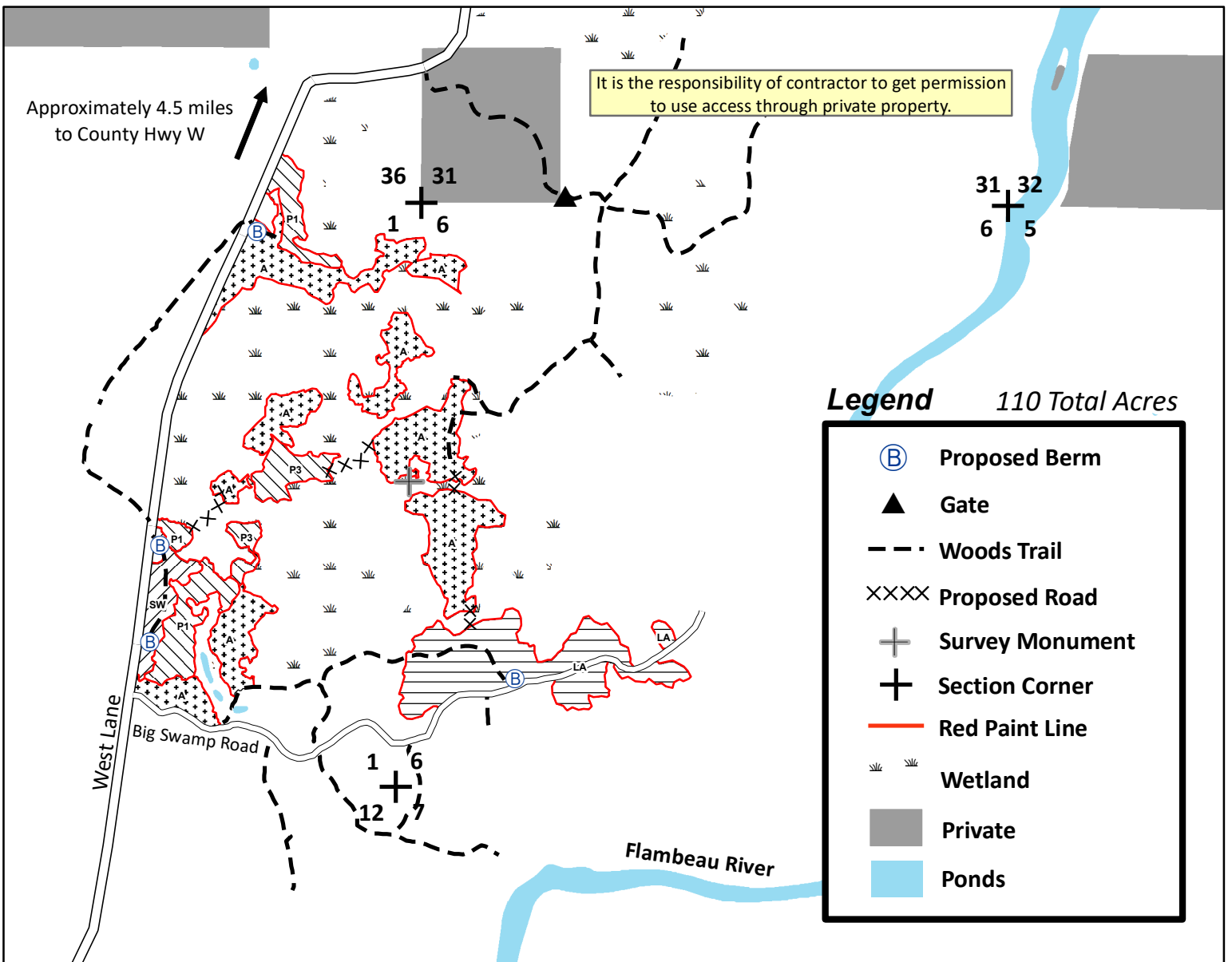

**Legend** 110 Total Acres

- Proposed Berm
- Gate
- Woods Trail
- Proposed Road
- Survey Monument
- Section Corner
- Red Paint Line
- Wetland
- Private
- Ponds

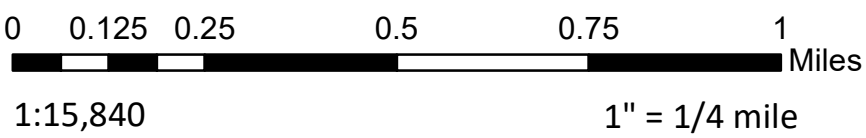

Mapped by Kristina Wells  
 \*This map is not a survey of the actual boundary of any property this map depicts\*

Contact Information: (715) 332-5271 ext. 106