

Tract 17-21 (Jump Scare) - Flambeau River State Forest

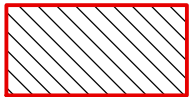

Parts of: SE ¼, SE ¼ SW ¼ Sec 12, N ½ NE ¼ Sec 13 T37N R3W Sawyer County
86 acres total



Selection Area (19 acres)- Bounded by red paint and Price Creek Road. Harvest all orange marked trees within the designated boundaries. Harvest all merchantable ironwood.

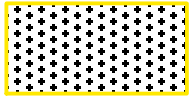

Aspen Area (58 acres)- Bounded by yellow paint and Price Creek Road. Cut all trees greater than 1" except for: 1) cedar, 2) hemlock, 3) white pine, 4) oak, 5) elm, 6) cherry, and 7) spruce two-sticks or less.

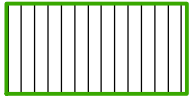

Shelterwood Area (9 acres)- Bounded by green paint. Harvest all trees greater than 1" except for: 1) all hemlock and white pine, and 2) all green marked trees (green band). Sever all unmerchantable stems except for aspen.

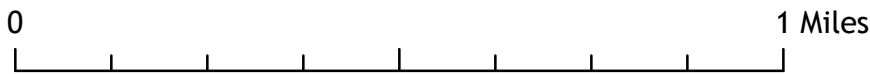
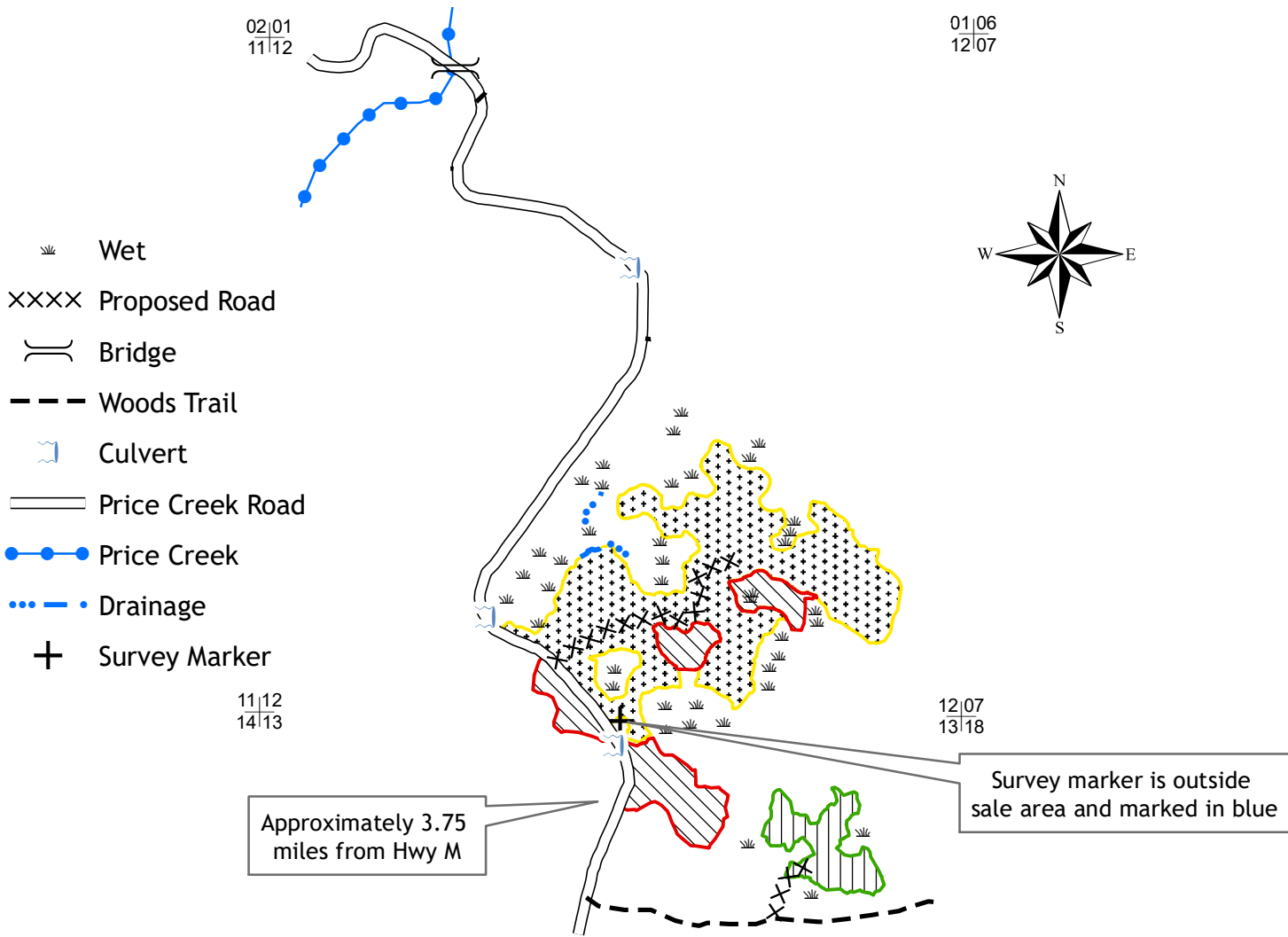

1:15,840

Contact information: 715-332-5271 ext 106

Mapped by Taylor Lockwood

This map is not a survey of the actual boundary of any property this map depicts