

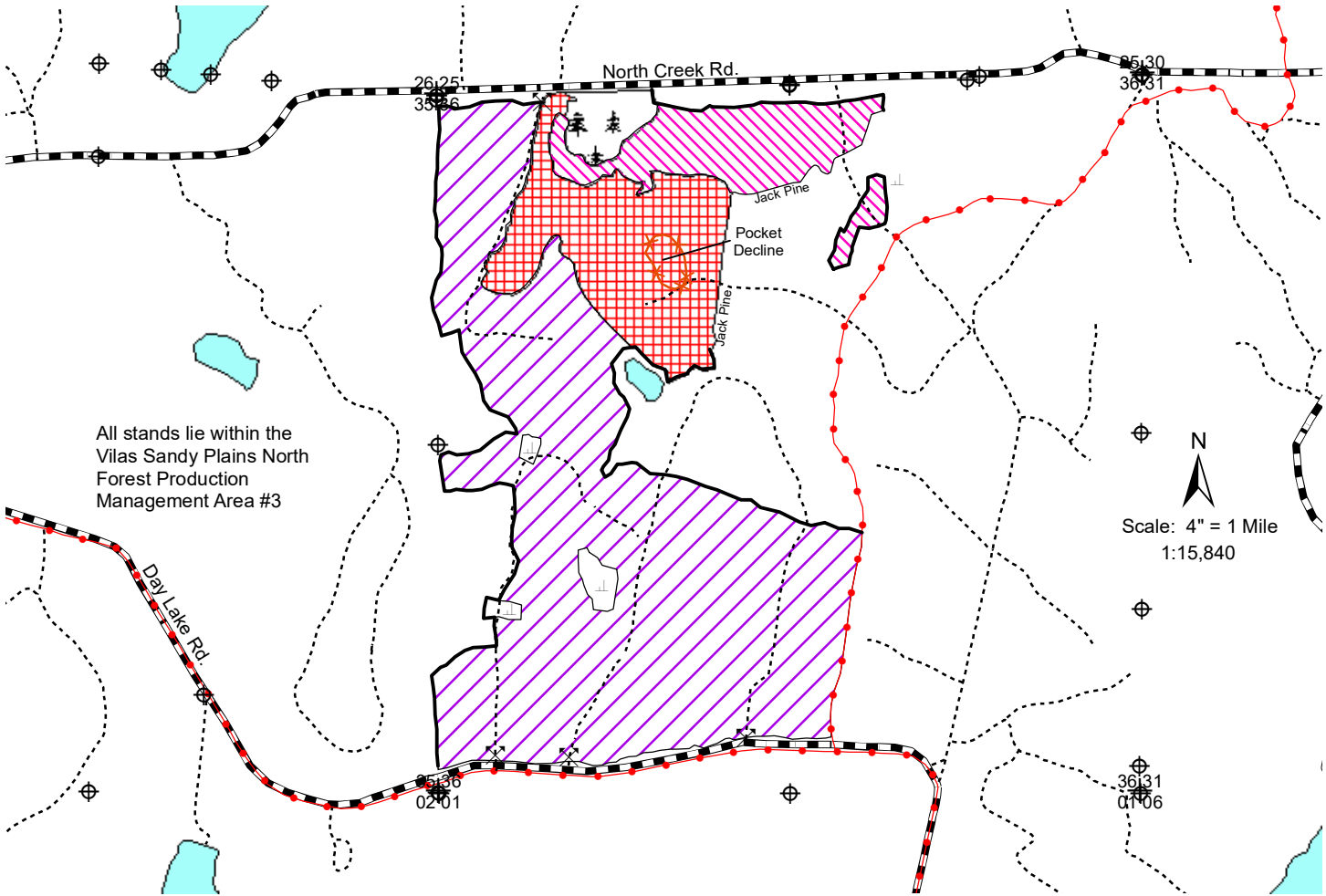



**WISCONSIN
DEPARTMENT OF NATURAL RESOURCES
TIMBER SALE
TRACT 17-22 NORTH CREEK WILD APPLE
T42N R6E SECTIONS 36
HARVEST ACRES - 257**







N
Scale: 4" = 1 Mile
1:15,840

Map produced by
Chase Christopherson, 08/22

This map is not a survey of the actual boundary of any property this map depicts.

- Legend**
-  Grass Opening
 -  Berms
 -  Survey Marker
 -  Section Corner
 -  Red Line
 -  Yellow Line
 -  Snowmobile Trails
 -  Woods Roads
 -  Highways and Town Roads
 -  Lakes

-  White Pine (7 Acres): Cut all aspen, balsam fir, maple, white birch and orange marked trees.
-  Aspen (28 Acres): Cut all aspen, balsam fir, maple, white birch and orange marked trees. Cut all aspen and maple 2-5" in diameter.
-  Red Pine (43 Acres): Cut all aspen, balsam fir and orange marked trees. Cut all red pine within pocket decline area.
-  Aspen/Oak (179 Acres): Cut all aspen, balsam fir, maple, white birch and orange marked trees. Cut all aspen and maple 2-5" in diameter.

**Note: No harvesting, skidding or road building in Aspen/Oak stand April 15 - July 15 due to the risk of Oak Wilt.
Do NOT cut trees marked with green paint.**

NH-ALSF TRACT NO. 17-22

North Creek Wild Apple

Vilas County

Town 42 North, Range 6 East

Section 36 – NWNE, NW ¼, SW ¼, NWSE, SWSE

15% of the total sale bid value will be required for performance bond.

The cutting area is approximately 257 acres.

All trees that will yield one or more 100-inch sticks to the minimum top diameter will be cut and utilized.

Whole Tree harvest is allowed*.

<u>ESTIMATED VOLUME (TONS)</u>		
<u>MINIMUM TOP DIAMETER</u>		
<u>SPECIES</u>	<u>4"</u>	<u>Whole Tree</u>
White Pine ¹	380	N/A
Red Pine ²	1,100	N/A
Aspen	7,550	10,250
Red Oak ³	300	420
Mixed Hardwoods ⁴	800	1300
TOTAL MINIMUM BID VALUE: \$ 110,299.00		

1 White Pine consists of 80% white pine, 15% jack pine, 4% balsam fir and 1% white spruce. Included is an estimated 10 MBF of sawlog material. Wt Avg = 2.104 tons/cord.

2 Red Pine includes an estimated 85 MBF of sawlog material.

3 Red Oak includes an estimated 10 MBF of sawlog material.

4 Mixed Hardwood consists of 64% white birch and 36% red maple. Wt Avg = 2.355 tons/cord.

Note: Total sale volume equates to 39.2 tons/ac. or 17.3 cords/ac. (4" top); 54.1 tons/ac. or 23.9 cords/ac. (WT).

Special Conditions:

1. No harvesting, skidding or road building Aspen/Oak stand April 15th to July 15th due to the risk of oak wilt.
2. *No biomass harvest of pine allowed.
3. Shortwood forwarding only in red pine plantation. Pole skidding may be allowed with DNR forester approval.
4. Grass Openings may not be used for decking or truck turnarounds.
5. All slash within 50 feet of any road or trail must be lopped and scattered to lie within two feet of the ground and pulled back at least ten feet behind the tree line concurrently with cutting.
6. All pine products cut between April 1 and September 1 must be removed from the sale area within three weeks from time of cutting. Pine products cut during the remainder of the year must be removed prior to April 1 of each year.