

**WISCONSIN
DEPARTMENT OF NATURAL RESOURCES
TIMBER SALE
TRACT 2-22 VANDERCOOK STEEL WHEELS
T41N R6E SECTIONS 36
T41N R7E SECTIONS 30, 31
HARVEST ACRES -172**

This sale is located within
Management Area 5: Big Arbor
Vitae Loam Hills Forest Production
Area

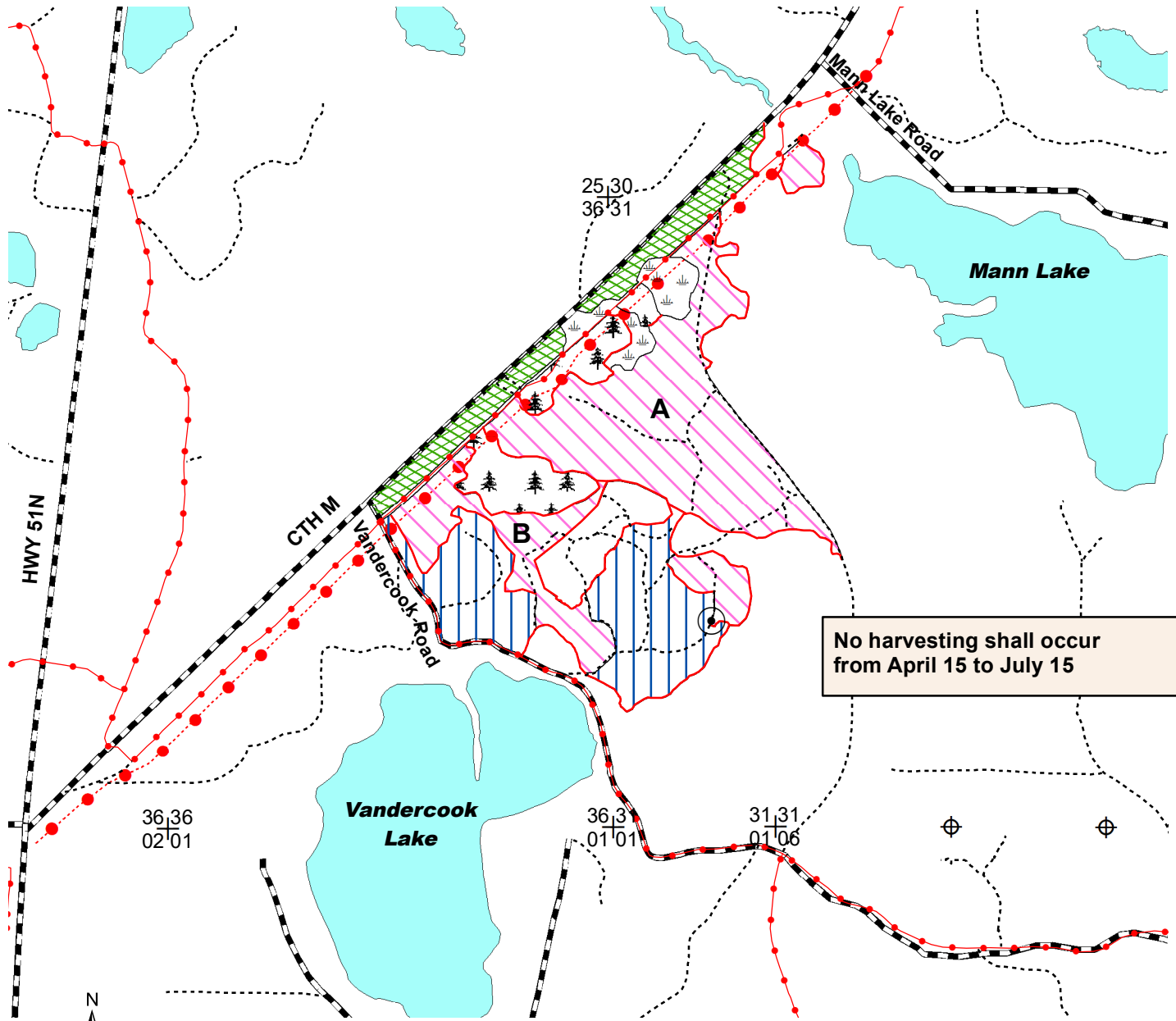

**No harvesting shall occur
from April 15 to July 15**

**Note: Do NOT cut any trees marked with green paint.
Equipment will not be allowed to operate within 15 feet of wetlands.**

**1:15,840
Scale: 4" = 1 mi**

Legend

- Ground Water Quality Monitoring Well
- Survey Marker
- Section Corner
- Keg/Swamp
- Red Line
- Powerline
- Snowmobile Trails
- Woods Roads
- Highways and Town Roads
- Lakes & Open Water

- Selection Harvest Area (44 Acres) - Cut all aspen, merchantable balsam fir, ironwood, jack pine and orange marked trees.
- Pine Thinning (19 acres) - Cut aspen, merchantable maple, birch, jack pine, balsam fir, and orange marked trees
- Aspen Harvest Area (90 acres) - Cut all aspen, white birch, maple, cherry, ironwood, jack pine, merchantable balsam fir and orange marked trees. Within area A cut all 1-5 inch stems except oak, pine and birch. Within area B Do NOT Cut Any 1-5" stems
- Pine Thinning (19 Acres) - Cut all merchantable balsam fir and orange marked trees ONLY.



Map produced by
Paul Stearns, 03/14/22

This map is not a survey
of the actual boundary
of any property this maps depicts

NH-ALSF TRACT NO. 2-22
VANDERCOOK STEEL WHEELS

Vilas County

Town 41 North, Range 6 East

Section 30 SWSW, SESW

Section 31 W½ NW¼, NESW, W½ NW¼, SENW,

Town 41 North, Range 7 East

Section 36 GL1, GL2, SWNE, NWNE, NENE

No bid bond will be required.

15% of the total sale bid value will be required for performance bond.

The cutting area is approximately 172 acres.

The contract period is 3 years.

All trees that will yield one or more 100-inch sticks to the minimum 4" top diameter will be cut and utilized.

Whole tree utilization is NOT allowed.

ESTIMATED VOLUME (TONS)
MINIMUM TOP DIAMETER

<u>SPECIES</u>	<u>4"</u>
Red Pine ¹	700
Aspen	3000
Mixed Hardwood ²	2850
Balsam Fir	100

Total Minimum Bid Value: \$66,440.00

PR¹ --Approximately 63% (441 tons) Red Pine, and 37% (259 tons) White Pine, <1% Jack Pine. Includes approximately 50 MBF Red Pine sawlogs and 30MBF of White Pine sawlogs. (Wt. conv. 2.192 tons/cord)

MX² --Approximately 44% (1254 tons) Soft Maple, 28% (798 tons) Hard Maple, 20% (570 tons) White Birch, and 8% (228 tons) Red Oak, <1% Ironwood and Cherry. Includes approximately 5 MBF Red Oak and 4 MBF of Soft Maple, and 1MBF of Hard Maple. (Wt. conv. 2.406 tons/cord)

Note sale volume equates to 38 tons/acre or approximately 16 cords per acre.

Special Conditions:

1. **Operational Restrictions:** Due to concerns over the spread of oak wilt, no harvesting, skidding or road building will be allowed between April 15th and July 15th
2. Cutting must be concurrent for all species to be harvested.
3. Equipment will not be allowed to operate within 15 feet of wetlands.
4. Do not cut, knock down or utilized any dead trees, unless they pose a hazard to operator safety.
5. All pine products cut between April 1 and September 1 must be removed from the sale area within three weeks from time of cutting. Pine products cut during the remainder of the year must be removed prior to April 1 of each year.
6. Equipment Restrictions: Skidding of forest products will be restricted to shortwood forwarders only.
7. Snowmobile trails must be kept free of debris and left in good condition for vehicle traffic at all times. Trails will be signed entering harvest and hauling areas.
8. Decking of forest product will NOT be permitted along Vandercook Road.
9. All landings and any new roads must be approved prior to sale start up and returned to pre-harvest conditions or better.
10. Slash within 50 of all town roads and recreational trails must be lopped and/or scattered to lie within two feet of the ground and be pulled back 10' behind the tree line concurrently with cutting.
11. Felling and skidding damage to residual trees must be avoided.
12. If the contract is to be worked on during multiple time periods a mid-contract "pull-off" inspection meeting will be required. One-week notice shall be given by the contractor prior to moving equipment off-site. During the "pull-off" inspection provisions needing attention will be documented. The contractor at this time can decide to remedy them before pulling off or rectify them when moving back onto the site. If the latter is chosen documented items shall be addressed before harvesting can continue.