

1615

**WISCONSIN
DEPARTMENT OF NATURAL RESOURCES
TIMBER SALE
TRACT 6-22 HELEN HAWK
T38N R7E SECTIONS 22, 23, 26, 27 & 28
HARVEST ACRES - 303**

N
Scale: 4" = 1 Mile
1:15,840

This map is not a survey of the actual boundary of any property this map depicts.



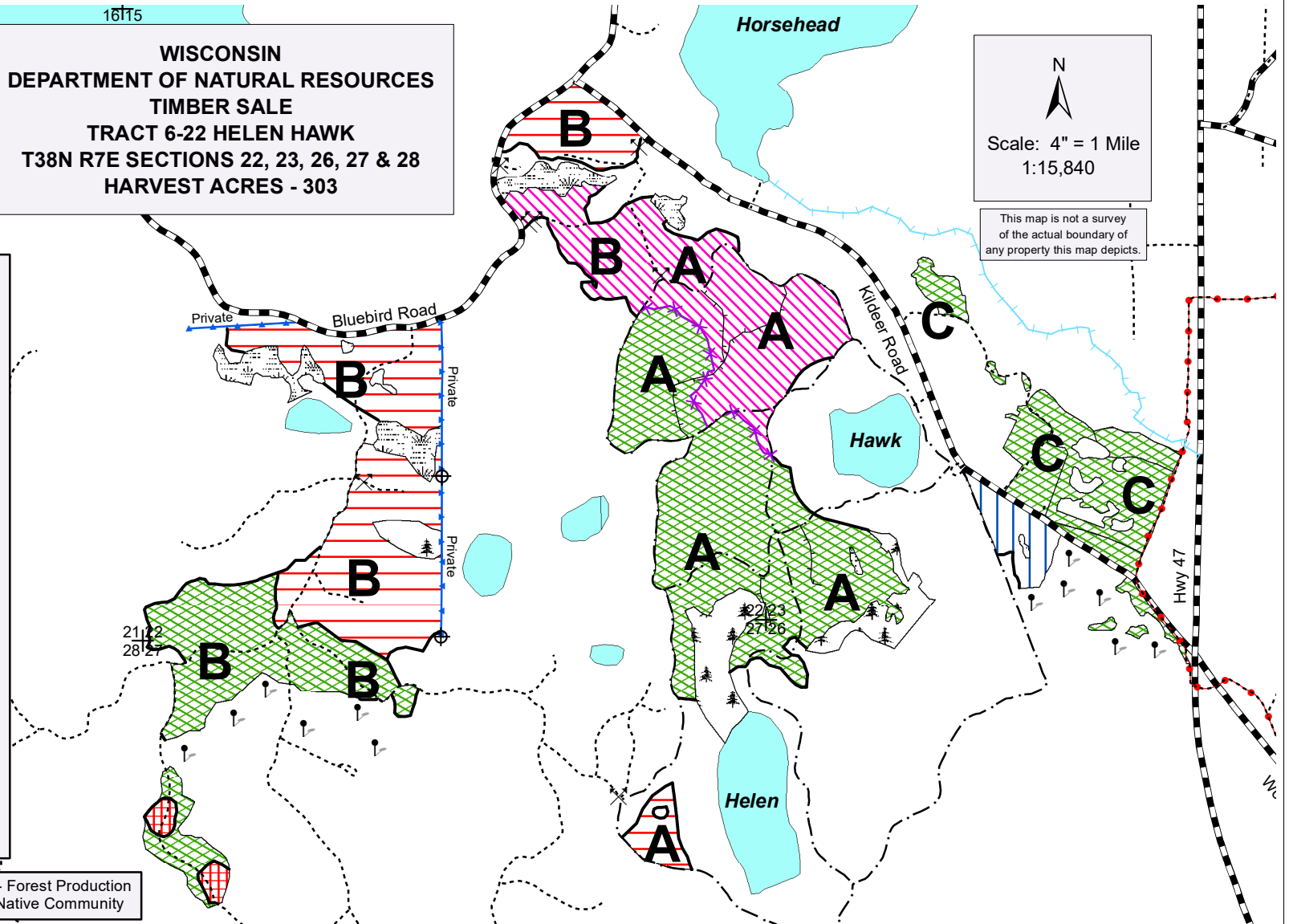

Legend

- ⊗ Berms
- ⊕ Survey Corner
- ⊕ Section Corner
- ↑ Aspen Saplings
- ✕ Purple Line
- Red Line
- Blue Line
- ⋯ Woods Roads
- Proposed Skid Route
- ⋯ Recreational Trail
- Snowmobile Trails
- ▬ Highways and Town Roads
- ▨ Lowland Area
- ▩ Swamp Conifer Area
- Lakes

Management Area 6: Oneida Sandy Plains - Forest Production
Management Area 11: Red & White Pines - Native Community

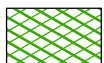
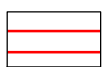

SEASONAL RESTRICTION: In ZONE A, all harvesting activity, including road building, is allowed July 15 - Dec. 1. In ZONE B, all harvesting activity, including road building, is allowed July 15 - April 15. In ZONE C, all harvesting activity is allowed Oct. 1 - April 1. All other sale areas have no restrictions.

-  Orange Marked Area (161 Acres): Cut all trees marked with orange paint.
-  Green Marked Area (76 Acres): Cut all trees except those marked with green paint.
-  Oak Area (55 Acres): Cut all trees except those marked with green paint. Cut only those red and white pine marked with orange paint.
-  Aspen Area (8 Acres): Cut all aspen, maple and orange marked trees.
-  Clearcut Area (3 Acres): Cut all trees.

NH-ALSF TRACT 6-22

Helen Hawk

Oneida County

Town 38 North, Range 7 East (Lake Tomahawk Township)

Section 22 – GL 01; NWNE; S1/2NE; SW1/4; E1/2SE

Section 23 – GL 02; SENW; SW1/4; W1/2SE

Section 26 – NWNE; NWNW

Section 27 – E1/2NE; N1/2NW; SWNW

Section 28 - SENE

No bid bond required.

15% of the total sale bid value will be required as performance bond.

The cutting area is approximately 303 acres.

The contract period is 3 years.

All trees that will yield one or more 100-inch sticks to the minimum top diameter chosen by the bidder will be cut and utilized.

Whole tree utilization is NOT allowed.

ESTIMATED VOLUME (TONS)

MINIMUM TOP DIAMETER

<u>SPECIES</u>	<u>4”</u>
White Pine ¹	2005
Red Pine ²	2950
Aspen	900
Red Oak ³	3570
Mx. Hardwood ⁴	1680

Total Minimum Bid Value \$ 146,454.00

¹Volume includes 86% white pine, 9% spruce, 4% balsam fir and 1% jack pine. It also includes approximately 210 MBF of potential white pine logs. Weighted average conversion is 2.092 tons/cord.

²Volume includes approximately 278 MBF of potential red pine logs.

³Volume includes approximately 204 MBF of potential oak saw logs.

⁴Volume includes 88% red maple, 7% sugar maple, 4% white birch and 1% ironwood. Volume also includes the potential for 10 MBF of sugar maple, 3 MBF of red maple and 1 MBF of white birch. Weighted average conversion is 2.296 tons/cord. The total sale volume equates to approximately 36.65 tons/acre or 15.52 cords/acre.

Special Conditions:

- SEASONAL RESTRICTIONS:** Zone A – Harvesting operations, including hauling, allowed July 15 – Dec.1. Zone B – Harvesting operations, including hauling, allowed July 15 – April 15. Zone C – Harvesting operations allowed Oct. 1 – April 1. Biomass harvesting is not allowed.
- Do not harvest trees or operate equipment within 15 feet of any ephemeral pond. Do not deposit any slash or tops in them.
- Cutting must be concurrent for all species to be harvested. Do not damage residual trees.
- All pine products cut between April 1 and September 1 must be removed from the sale area within three weeks from the time of cutting. Pine products cut during the remainder of the year must be removed prior to April 1 of each year.
- Do not cut, knock down or utilize any dead trees, unless they pose a hazard to operator safety.
- No tops or slash allowed across any blue line, red line, town road right-of-way or within any wetland. Slash within 50 feet of the town roads, snowmobile trail and all recreational trails must be lopped and scattered within 2 feet of the ground and be pulled 10’ behind the tree line concurrently with cutting.
- Minimize equipment crossing points over the McNaughton Recreational Trail system. Recreational trails must be kept free of slash and debris. Contractor will be responsible for maintaining, removing and replacing any recreational trail signs prior to each ski season.
- All landings and any new woods roads must be approved prior to sale start up.
- All ski and snowmobile trails must be repaired to pre-harvest condition upon sale completion or before removal of equipment from the sale area.
- If the contract is to be worked on during multiple time periods a mid-contract “pull-off” inspection meeting will be required. One-week notice shall be given by the contractor prior to moving equipment off-site. During the “pull-off” inspection, provisions needing attention will be documented. The contractor at that time can decide to remedy them before pulling equipment off or rectify them when moving back onto the site. If the latter is chosen, documented items shall be addressed before harvesting can continue.

