

**Wisconsin  
Department of Natural Resources  
Timber Sale  
Tract 13-23 No Hassle Aspen  
T38N R7E Section 30  
Harvest Acres - 56**

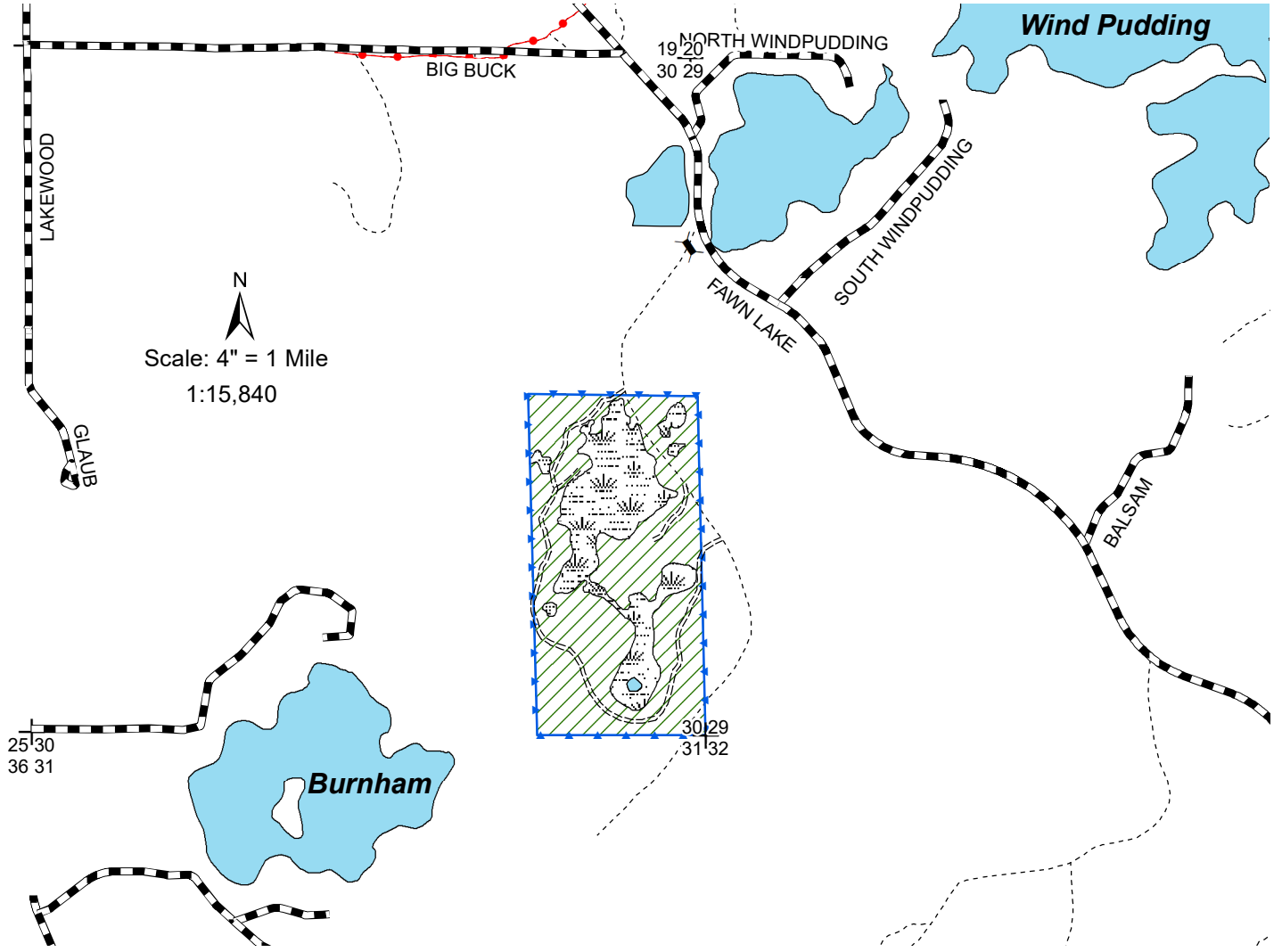

**Legend**

- Gates
- Section Corner
- Town and County Roads
- Snowmobile Trails
- Woods Roads
- Old Woods Roads
- Blue Line
- Keg
- Lakes

Harvest Area (56 Acres): Cut all aspen, maple, ironwood, and fir >1" DBH. Do not cut any oak, pine, spruce, or birch.

**Harvesting is allowed July 15th through April 15th.**

The entire sale area lies within Management Area 6: Oneida Sandy Plains - Forest Production  
 \*\*This map is not a survey of the actual boundary of any property this map depicts\*\*



NH-ALSF TRACT 13-23  
No Hassle Aspen

Oneida County

No bid bond required.

The cutting area is approximately 56 acres.

All trees that will yield one or more 100-inch sticks to a minimum top diameter of 4" will be cut and utilized.

Whole tree harvest is not allowed.

---

ESTIMATED VOLUME (TONS)  
MINIMUM TOP DIAMETER

	<u>4"</u>
Balsam Fir	40
Aspen	3250
Red Maple <sup>1</sup>	625

---

**Total Minimum Bid Value** **\$38,640.00**

---

<sup>1</sup> Volume includes less than 1% of ironwood.

The total sale volume equates to approximately 69.91 tons/acre or 31 cords/acre.

Special Conditions

1. Do not operate equipment or cut any trees within 15 feet of any ephemeral pond or wetland. Cutting must be concurrent for all species to be harvested.
2. Harvesting or road building is allowed from July 16<sup>th</sup> – April 14<sup>th</sup> due to oak wilt.
3. All slash must be pulled back at least 25 feet away from any road or trail.
4. No slash allowed across any blue line, or within any wetland. Slash must be lopped and scattered to lay within 2 feet of the ground and pulled back into the sale area at least 10 feet away from the adjacent private lands.
5. All landings and any new woods roads must be approved prior to sale start up.
6. The contractor will be responsible for gaining access to the sale through private land.
7. If the contract is to be worked on during multiple time periods a mid-contract "pull-off" inspection meeting will be required. One-week notice shall be given by the contractor prior to moving equipment off site. During the "pull-off" inspection, provisions needing attention will be documented. The contractor at that time can decide to remedy them before pulling equipment off or rectify them when moving back onto the site. If the latter is chosen, documented items shall be addressed before harvesting can continue.
8. Access to the sale will be through private land. Securing access will be the responsibility of the logger, but adjacent landowners have been receptive to granting access. Landowner names and phone numbers will be available upon request.

**Notice:** Completion of this form is mandatory. The Department will not recognize your bid unless you complete and submit this form. Personal information collected will be used for program administration and may be provided to requesters as required by Wisconsin's Public Records law [ss. 19.31-19.39, Wis. Stats.].

Date

Bidder Name

Street Address

City

State

ZIP Code

Property Name (if any)

NH-AL STATE FOREST

Timber Sale Name

No Hassle Aspen

Tract Number

13-23

Date and Hour of Bid Opening

1:30pm-November 15, 2023

Minimum Acceptable Bid (optional)

\$38,640.00

Species-All bids including Lump Sum bids must be by species	Utilization Specifications (4 inch/Whole Tree/Logs)	Estimated Volume	Volume Units (tons/cords/mbf)	Price Bid Per Unit	Total Bid Value on Estimated Volume
Balsam Fir	4 inch	40	tons		
Aspen	4 inch	3,250	tons		
Red Maple	4 inch	625	tons		

The award shall be based on this TOTAL BID AMOUNT:

**Performance Bond**

Will be in the form of: (select one)

- Personal Check
  Assurance Bond  
 Certified Check/Money Order
  Certificate of Deposit  
 Irrevocable Letter of Credit
  Assignment of Savings Account

I understand that any or all bids may be rejected and that consideration and awarding of a contract will be based upon my past performance and ability to complete contracts. **I also understand that if I am the winning bidder, I have 6 weeks from the date of the bid opening to submit an acceptable performance bond. I also understand that if I am awarded the contract and fail to execute it or work under it, I will be required to forfeit to the Department an amount equal to 10% of my total bid amount.** Failure to forfeit the 10% penalty will result in being considered ineligible to bid on any state timber sales for a two-year duration. In the event the highest bidder can not or will not sign the contract, the award may be made to the next highest qualified bid.

By checking this box, I certify that I hold a Wisconsin Master Logger Certification.

**Notice:** I understand:

Utilization specifications and estimated volumes are listed in the prospectus which is available upon request from the Department.

A copy of the standard timber sales contract which must be entered into is available upon request from the Department.

Signature of Bidder

Bidder's Name (Please Print or Type)

Phone Number (include area code)

Email Address