

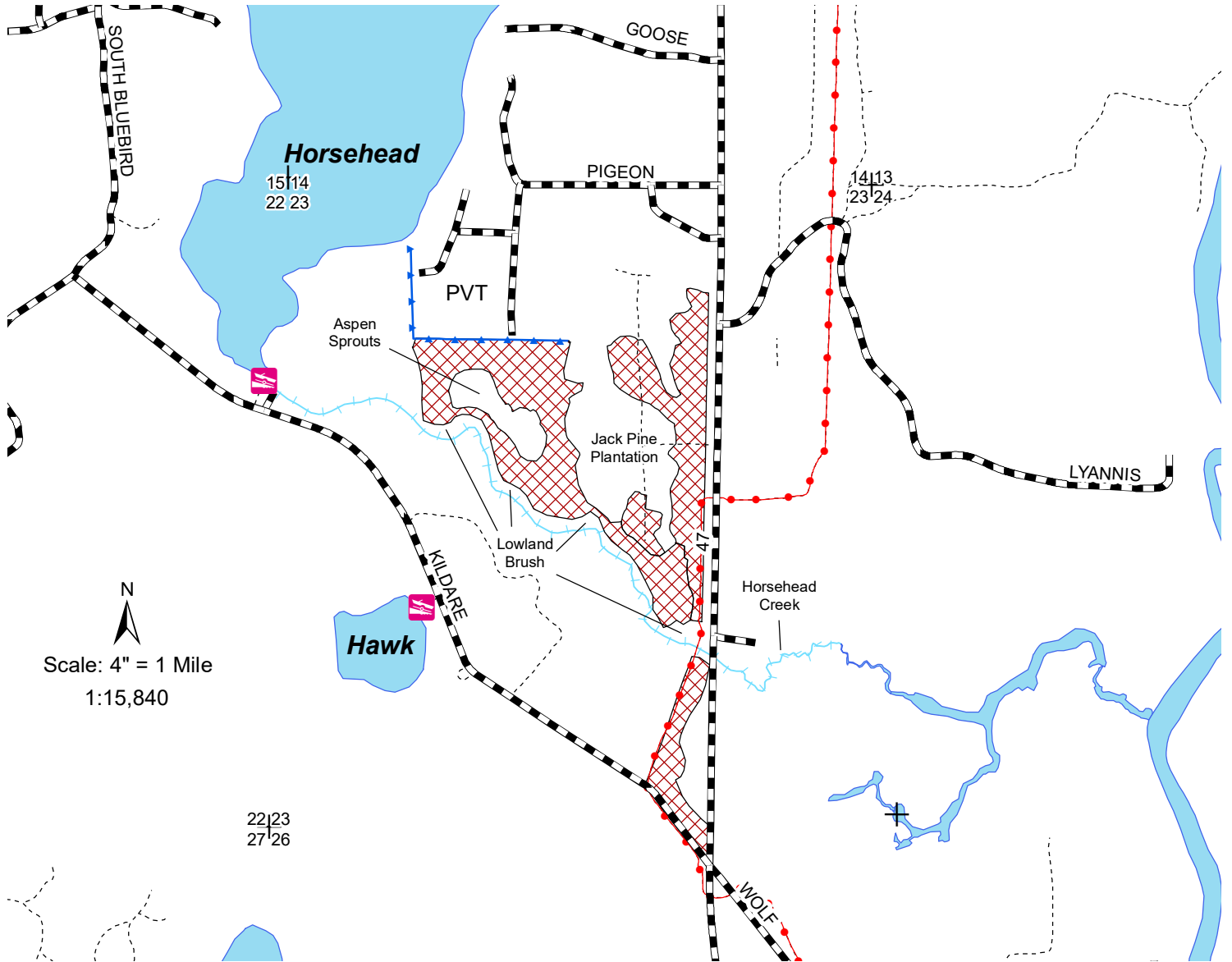

**Wisconsin
Department of Natural Resources
Timber Sale
Tract 18-23 Second Thinning
T38N R7E Section 23
Harvest Acres - 61**



N
Scale: 4" = 1 Mile
1:15,840

Legend

- Line
-  Boat Landing
- ⊕ Section Corner
- ▬ Town and County Roads
- Snowmobile Trails
- Blue Line
- - - Woods Roads
- Lakes
- Rivers and Streams

 Harvest Area (61 Acres) cut only those trees marked with orange paint.

Harvesting is allowed between October 1st and March 31st.

The entire sale area lies within Management Area 6: Oneida Sandy Plains - Forest Production
 This map is not a survey of the actual boundary of any property this map depicts

NH-ALSF TRACT 18-23
Second Thinning

Oneida County

The cutting area is approximately 61 acres.

All trees that will yield one or more 100-inch sticks to a 4" top diameter will be cut and utilized within the designated timber sale boundary.

Whole tree utilization is NOT allowed.

ESTIMATED VOLUME (TONS)
MINIMUM TOP DIAMETER

SPECIES
Red Pine¹

4"
2475

Total Minimum Bid Value: \$45,045.00

¹Approximately 95% red pine and 5% white pine. Included is an estimated 315 MBF of potential sawlogs
The total sale contains approximately 40 tons/acre or 17 cords/acre.

Special Conditions:

1. Harvesting will be allowed between October 1st – March 31st.
2. All pine products remaining on the landing after April 1st must be removed from the sale area within three weeks.
3. Minimize damage to any of the residual trees or seedling/saplings.
4. No harvesting of unmarked pine, oak, and spruce, plus retaining wildlife trees, such as trees with cavities or loose, sloughing bark, and snags, dead trees, broken off limbs, or hazard trees that are not marked unless they pose an immediate safety hazard.
5. Slash must be lopped and/or scattered to lie within two feet of the ground and pulled back at least ten feet behind the tree line concurrent with cutting. No tops or slash allowed across any red line, blue line, wetland, or within the DOT row.
6. Follow WI BMPs for water quality at all times.
7. Additional roads and landings must be approved by the timber sale administrator (or designee) in advance of use.
8. All existing woods roads must be left in good condition and be restored to pre-harvest condition upon sale completion.
9. The snowmobile trail must be restored to the original presale condition after the harvest.
10. Trails will remain open and always kept free of hazards during the timber harvest. When the harvest is occurring, proper "Logging Ahead" signs will be placed on all the trails that the snowmobiles use for the public's safety.
11. All slash to be pulled back 25' from snowmobile trail. Lopping of slash to within 2 feet of the ground.
12. If the contract is to be worked on during multiple time periods a mid-contract "pull-off inspection meeting will be required. One-week notice shall be given by the contractor prior to moving equipment off-site. During the "pull-off" inspection provisions needing attention will be documented. The contractor at this time can decide to remedy them before pulling off or rectify them when moving back onto the site. If the latter is chosen documented items shall be addressed before harvesting

Note: In order to fill and save this form electronically, it must be opened using Adobe Reader or Acrobat software. Save a copy of the file, open Adobe Reader, select File > Open and browse for the file you saved.

State of Wisconsin
Department of Natural Resources
dnr.wi.gov

Timber Sale Bid
Form 2400-049 (R 07/22)

Notice: Completion of this form is mandatory. The Department will not recognize your bid unless you complete and submit this form. Personal information collected will be used for program administration and may be provided to requesters as required by Wisconsin's Public Records law [ss. 19.31-19.39, Wis. Stats.].

Date

Bidder Name

Street Address	City	State	ZIP Code
----------------	------	-------	----------

Property Name (if any) NH-AL STATE FOREST	Timber Sale Name Second Thinning	Tract Number 18-23
--	-------------------------------------	-----------------------

Date and Hour of Bid Opening 1:30pm-November 15, 2023	Minimum Acceptable Bid (optional) \$45,045.00
--	--

Species-All bids including Lump Sum bids must be by species	Utilization Specifications (4 inch/Whole Tree/Logs)	Estimated Volume	Volume Units (tons/cords/mbf)	Price Bid Per Unit	Total Bid Value on Estimated Volume
Red Pine	4 inch	2,475	tons		

The award shall be based on this TOTAL BID AMOUNT:

Performance Bond

Will be in the form of: (select one)

- | | |
|--|---|
| <input type="radio"/> Personal Check | <input type="radio"/> Assurance Bond |
| <input type="radio"/> Certified Check/Money Order | <input type="radio"/> Certificate of Deposit |
| <input type="radio"/> Irrevocable Letter of Credit | <input type="radio"/> Assignment of Savings Account |

I understand that any or all bids may be rejected and that consideration and awarding of a contract will be based upon my past performance and ability to complete contracts. **I also understand that if I am the winning bidder, I have 6 weeks from the date of the bid opening to submit an acceptable performance bond. I also understand that if I am awarded the contract and fail to execute it or work under it, I will be required to forfeit to the Department an amount equal to 10% of my total bid amount.** Failure to forfeit the 10% penalty will result in being considered ineligible to bid on any state timber sales for a two-year duration. In the event the highest bidder can not or will not sign the contract, the award may be made to the next highest qualified bid.

By checking this box, I certify that I hold a Wisconsin Master Logger Certification.

Notice: I understand:

Utilization specifications and estimated volumes are listed in the prospectus which is available upon request from the Department.

A copy of the standard timber sales contract which must be entered into is available upon request from the Department.

Signature of Bidder
Bidder's Name (Please Print or Type)
Phone Number (include area code)
Email Address