

**Northern Highland - American Legion State Forest
C160H Stand 1
Trout Lake Oak - 248 Acres
Town of Boulder Junction
T41N R6E Sections 1 and 12
T41N R7E Section 6
NHAL Master Plan: Area 12 - Mixed Forest Native Community**

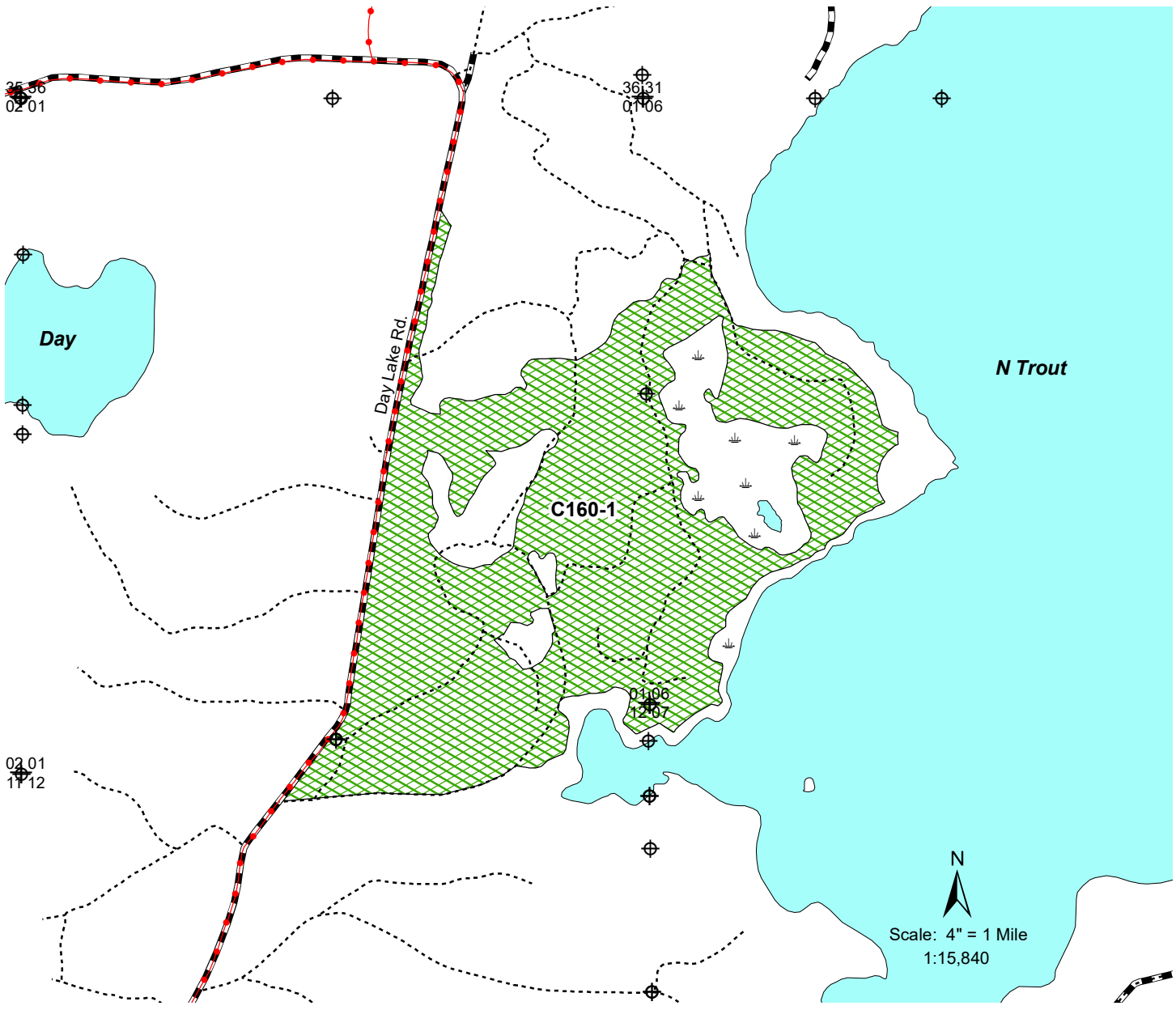

Legend	
	Keg/Swamp
	Survey Marker
	Section Corner
	Snowmobile Trails
	Woods Roads
	Highways and Town Roads
	Oak
	Lakes

Stand 1 (248 acres) Red Oak – 113 y.o. This well stocked stand of large sawlog red oak will be marked following the Common Priorities for Removal and Retention with the objective of thinning the stand and enhancing the growth of large vigorous trees.



Map produced by Anderson & Christopherson, 04/23

This map is not a survey of the actual boundary of any property this map depicts.